

# Conference/Meeting Facilities at Barnsdale Lodge

The many 17<sup>th</sup> Century farm buildings that make up Barnsdale Lodge have been sympathetically converted into 44 individually designed en-suite bedrooms and several private dining rooms. A host of meeting rooms are available to suit any occasion and there is a separate Barn which is perfect for parties, large dinners or product launches. There is also a beauty treatment room for the perfect relaxing end to a busy day.

Barnsdale Lodge are delighted to be able to offer you the latest facilities, a superb setting and an individual personal service.

## We work hard to make your event special

Barnsdale Lodge offer a range of facilities and rooms to suit any kind of event from 2 to 330 people, formal or informal. Rest assured your occasion will be a special one, whether it is a small gathering for a morning meeting, a larger conference or seminar, a training session, product launch, car show, international trade show, open day, interview, private dinner, award ceremony or if you would just like to use the facilities for corporate entertaining and company presentations, our professional and attentive staff will be on hand to ensure your event runs smoothly.

Our meeting and conference rooms are fully equipped with all of the latest facilities including projector screens, flip charts, BT direct dial telephones and broadband connections. Conference packs, pads and pencils, mineral water, soft drinks and boiled sweets are also supplied in each room.

Many other services are also available if booked in advance, such as fax and photocopying, TV and video, LCD multimedia projector, public address systems and secretarial support.

We can also arrange and facilitate a vast array of team building activities, either as a full day package or to fit in with a meeting or conference, including water sports, team building logic games,

rock climbing, sailing, fishing and cycling – see our team building brochure insert for full details.

Parking at Barnsdale Lodge is free with room for 200 cars and the facility to designate separate car parks for your conference delegates.

## Catering for your event

The locally renowned chefs at Barnsdale Lodge are able to accommodate any particular requirement from a daily delegate package of morning coffee, lunch and afternoon tea, through to a prestigious gala dinner, informal barbeque or tailored private dining. They aim to use fresh, local and seasonal ingredients in all of their dishes and can cater for any specific dietary requirement.

## Accommodating delegates in comfort

Barnsdale Lodge has 44 individually designed en-suite bedrooms ranging from singles, twins and doubles. All rooms have direct dial telephones, secure broadband connections, TV, tea and coffee making facilities and iron with ironing board. Additional accommodation can also be arranged in the locality.

## We have a reputation for quality

Event organisers return to Barnsdale Lodge again and again because of the quality of the facilities and the outstanding service. The hotel is awarded three stars and one rosette by the AA, is recognised by The Good Hotel Guide and is a member of the Great Inns of Britain.

## Viciénté Beauty Treatment Room at Barnsdale Lodge

Our conference and meeting guests can also benefit from our beauty treatment room. After a busy day why not unwind with a luxurious Viciénté facial or pampering massage. We advise booking all treatments in advance to avoid disappointment.

# Room Comparison Chart

(please also refer to our Room Overview Chart on Folder Pocket)

## The Barn

The largest venue at Barnsdale Lodge, The Barn is a self-contained conference facility on the ground floor. This is an ideal venue for presentations and entertaining on a large scale.

The Barn stands in the grounds of Barnsdale Lodge and has the following facilities:

- Private entrance
- Drive through triple doors both ends
- Reception area
- Cloaks reception and storage
- Toilets (inc disabled)
- Bar
- Kitchen
- Patio
- Stage area with PA facilities
- Dance floor
- Ample electrical connections
- Flexible lighting system with dimmers
- Can extend the space with marquees

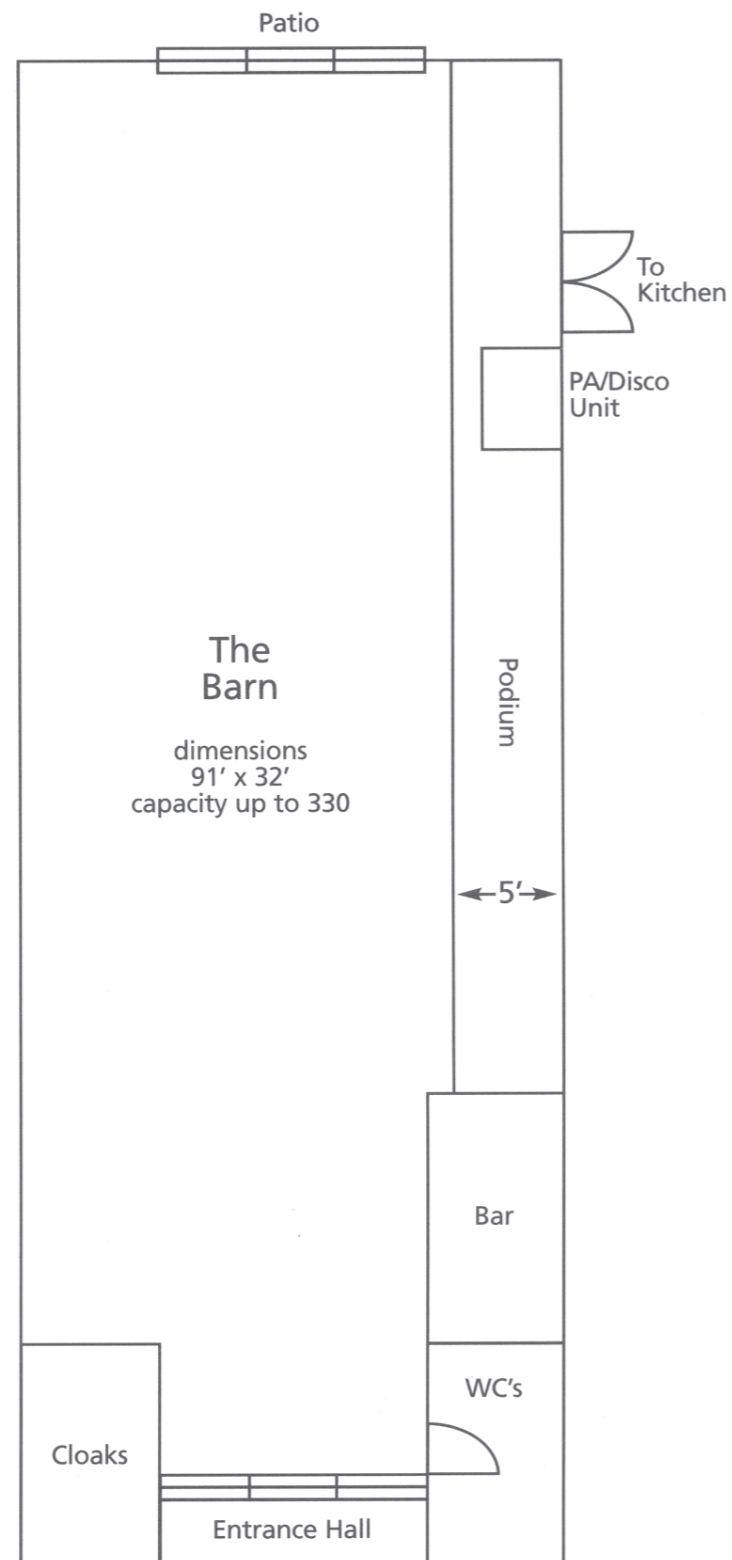

## The Rigate Suite and The Fort Henry Suite

These two suites are both on the first floor adjacent to one another. These are smaller suites but with full conference facilities. They inter-connect and can be used together, making them ideal for syndicated training and staff interview situations, as well as many other uses.

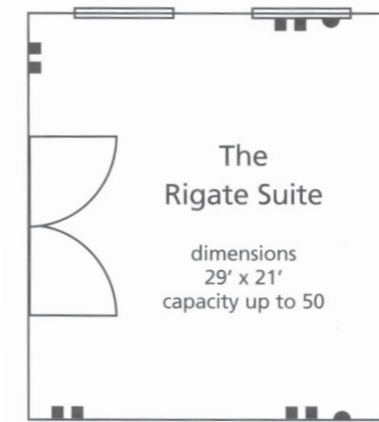

### The Rigate Suite

The Rigate Suite is a superb medium sized meeting room which is well appointed, air conditioned and naturally lit. It is naturally lit with windows on both sides. There is a facility for a private catering service. This suite is ideal for small receptions, displays and training sessions or conferences.

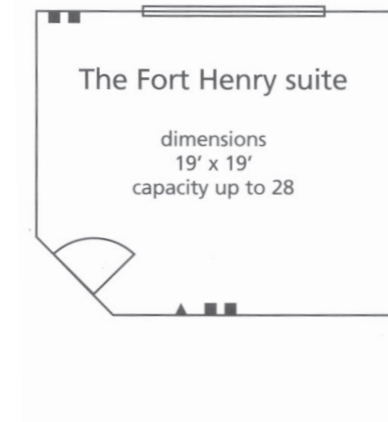

### The Fort Henry Suite

The Fort Henry Suite is a smaller room, ideal for an intimate working dinner party, private meeting or special event. This suite is naturally lit, with a view over Rutland Water. The suite is designed so that discreet service can be provided for any event.

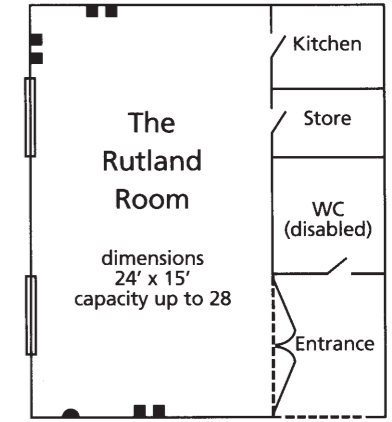

### The Rutland Room

The Rutland Room is a medium sized function suite with a private entrance and full conference facilities including a large plasma screen TV. This suite is designed for flexibility to accommodate the needs of training sessions, private dining, seminars, research groups and other meetings.

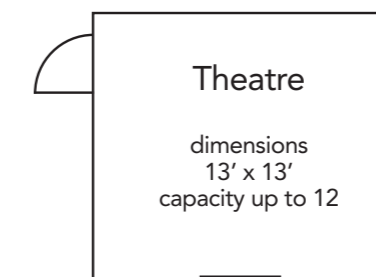
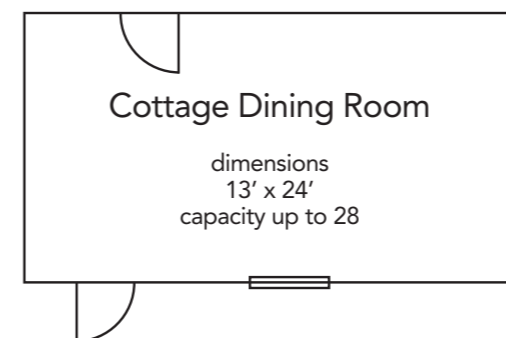

### The Cottage and Theatre

The Theatre and The Cottage are ideal for breakfast meetings and syndicate rooms and can also be used for informal private meetings.

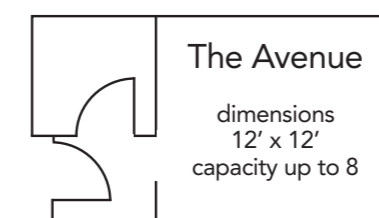
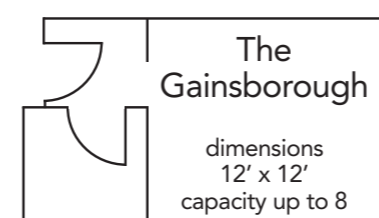

### The Gainsborough and The Avenue

The Gainsborough and the Avenue are ideal syndicate rooms set in a private location with ensuite facilities.

# Conference Rates

**Delegate Rate Including Room Hire:** Morning Coffee, 2 Course Lunch Menu (or Buffet Lunch), Afternoon Tea and Main Room Hire. Equipment included; Screen and Flipchart. TV and Video available by prior request

**Daily** - £35 + VAT per person

**24 Hour** - £112.50 + VAT per person  
(Includes bed, breakfast and 3 course dinner and full day delegate package)

**Broadband** Connection for multiple use Complimentary  
Single use Complimentary

**Additional Equipment** (Price includes VAT)  
Extra Flip Chart Pads £8.50 each  
LCD Multimedia Projector Complimentary  
Giant Screen (6 x 8 Feet) Complimentary  
Laptop £50 per day

**Room hire charges** Do not apply to delegate rates unless syndicate rooms are required

Room	Rate (full day)	Rate (half day)	Full day syndicate	Half day syndicate
Barn Suite	£500 + vat	£300 + vat	-	-
Rigate Suite	£200 + vat	£150 + vat	£90 + vat	£50 + vat
Fort Henry	£180 + vat	£120 + vat	£70 + vat	£30 + vat
Rutland Room	£200 + vat	£150 + vat	£90 + vat	£50 + vat
Cottage	£180 + vat	£120 + vat	£70 + vat	£30 + vat
Theatre	£180 + vat	£120 + vat	£70 + vat	£30 + vat
Gainsborough	£180 + vat	£120 + vat	£70 + vat	£30 + vat
Avenue	£180 + vat	£120 + vat	£70 + vat	£30 + vat

**Note:** Full day is 7.00am to 6.00pm  
Half day is 7.00am to 12 midday or 1pm (dependent on availability) to 6.00pm

**Supplements** (Inc of VAT) **Charges per person for additional:**  
Coffee £1.95  
Continental Breakfast £5.95  
Full English Breakfast £9.95  
2 Course Lunch (or Buffet Lunch) £15.00  
Dinner £27.50